

# 9/11 Heroes Run Doylestown, PA

Course has been measured in accordance with USATF/RRTC requirements, using the Shortest Possible Route (SPR) Method to within 12" of all curbs and road edges.

The entire course will have unrestricted racing. Runners will be able to utilize the entire width of all roads, paths, and the track.

Elevations were obtained using LiDAR data provided by PAMAP Program, PA Dept. of Conservation and Natural Resources, Bureau of Topographic and Geologic Survey.

Measured by Tom Rafferty, Hatboro PA 2/28/19

1:10,000



Starting Line Coordinates  
(in decimal degrees)  
40.3048, -75.1399

**Elevations:**  
(in meters)  
Start: 115.9  
Finish: 116.2  
Highest: 115.9  
Lowest: 135.9

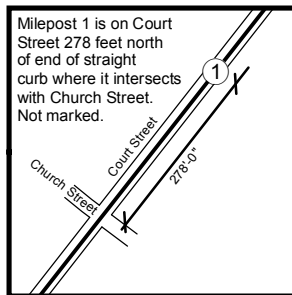
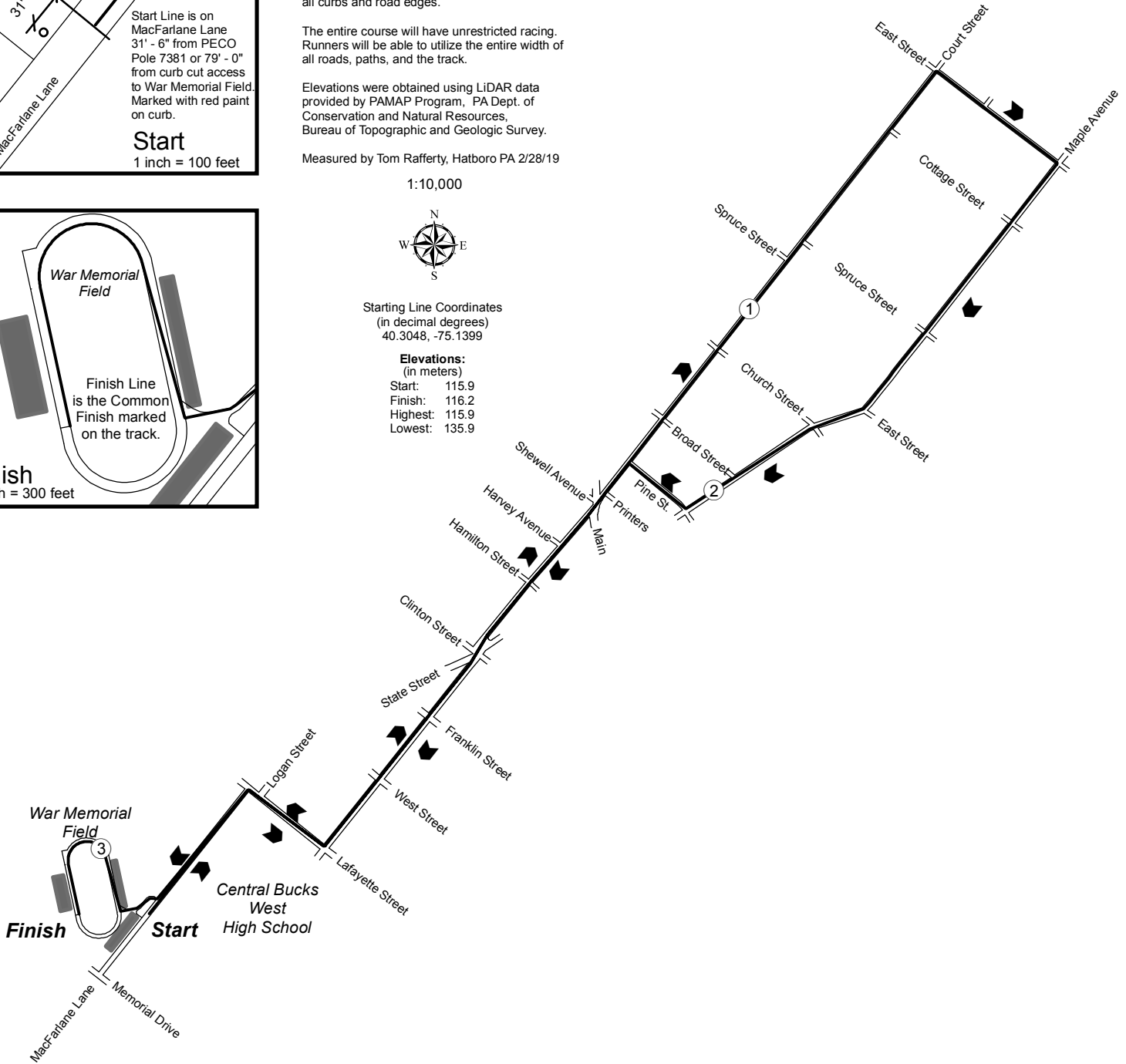
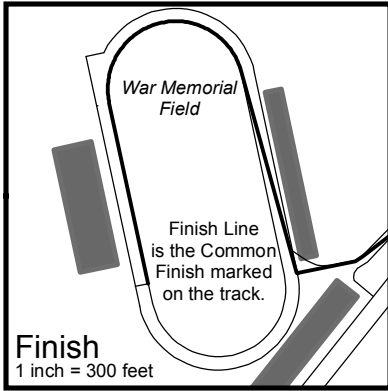
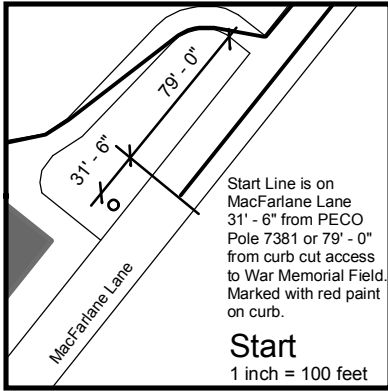

Mile 1  
1 inch = 300 feet

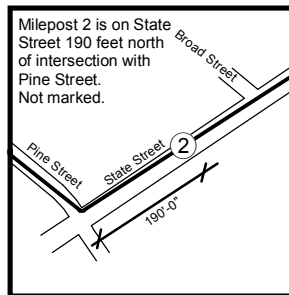

Mile 2  
1 inch = 300 feet

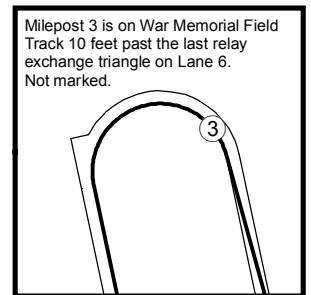

Mile 3  
1 inch = 300 feet